

SCHEMATIC

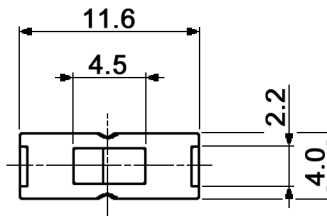
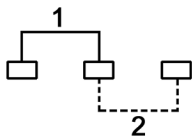

Specifications:

Contact rating: 0.3A, 125V AC (50-60Hz); 0.35A, 30V DC
Contact resistance: 20mOhm max.
Insulation resistance: 100MOhm min. at 500V DC
Dielectric strength: 500V AC for 1 minute
Mechanical life: 10 000 cycles
Contact timing: non-shorting
Soldering conditions: see process limitation below
Operating force: 150 +/-100gf
Material: Case: polyacetal
 Slider: PC
 Stator: PBT G - 30%
 Terminal: copper alloy, silver plated
 Contact: phosphor bronze, silver plated

Process limitation:

JEDEC J-STD-075 class W4Y
 pre-heat max. 100°C / max. 60sec.
 time in wave 5sec. max.
 terminal peak temperature 260°C
 1 pass
 no liquid cleaning

Compliance: RohS II (2011/65/EU)

Tolerances: ±0.2mm	Date	Name	<h1>MFP 161 D</h1>
	02/06	dr	
DC-rating	05/14	dr	<h2>30 07 88</h2>
Process limitation	05/09	dr	
Modifications	Date	Name	Page
			1/1